

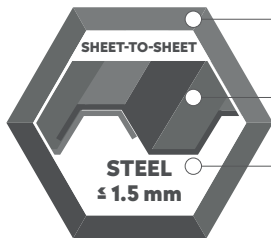

# SELF-DRILLING METAL SCREW PRO

## APPLICATION



SS SUS410

Sheet-to-sheet

Steel ≤ 1,5 mm

## SPECIFICATION

- 1 Head style 8 mm
- 2 Washer diameter standard 16 mm
- 3 SS with EPDM bond seal
- 4 Thread for substructure steel ≤ 1,5 mm
- 5 Sharp drilling point

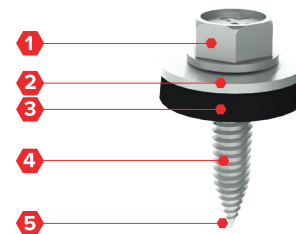

## OPTIONS

- 1 Powder coated in any desired colour

## SECTION

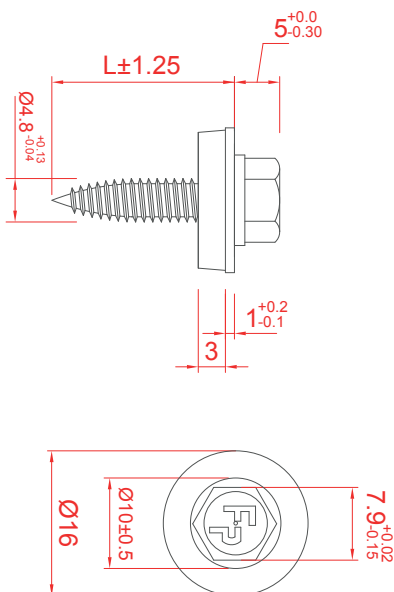

STITCHING SCREWS - STEEL ≤ 1,5 MM - SS SUS410

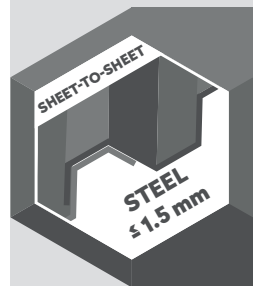

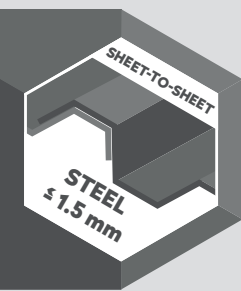
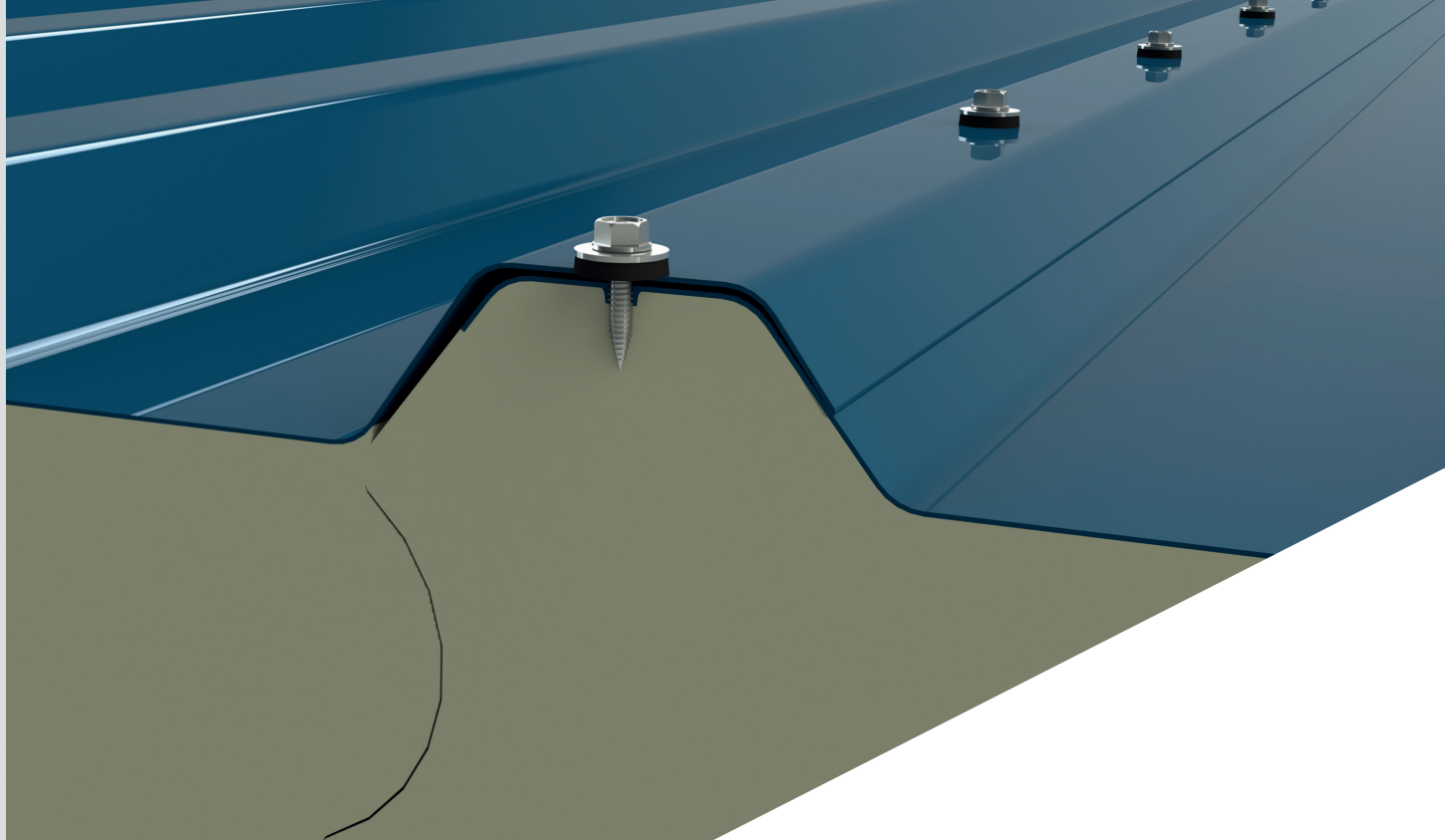

### SCREW POSITION

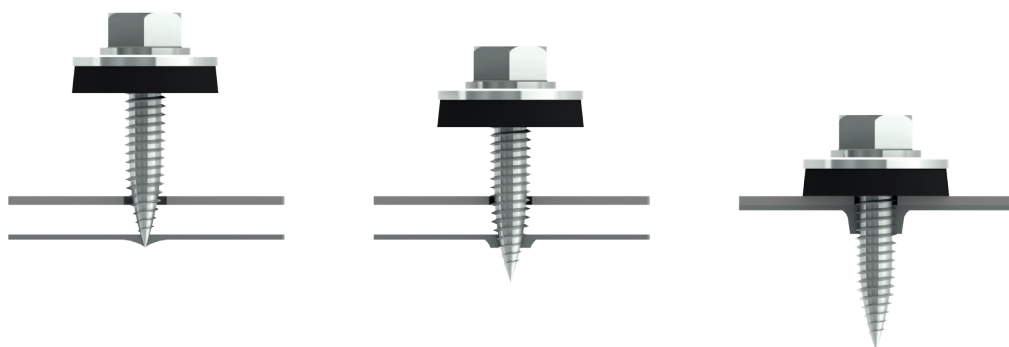



### ORDER INFORMATION

Product	Size	Packaging	Article code
Self-Drilling metal screw PRO 4,8 x L	20 mm	250 pcs/box	2003004802016



More information on materials, application, specific properties and certification can be found in chapter 10.

**SELF-DRILLING METAL SCREW PRO 4,8 X L**

Materials		 
Screw	SS 1.4006 (SUS410) - conform EN3506	
Washer	SS 1.4301 (A2) - conform EN3506	
Material A ( $t_I$ )	S280GD, S320GD and S350GD conform EN 10346	
Material B ( $t_{II}$ )	S235 conform EN 10025-2, S280GD, S320GD and S350GD conform EN 10346	
Drilling capacity	Steel $\leq 1,5$ mm	

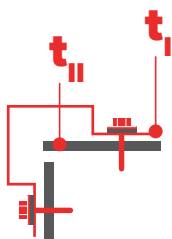

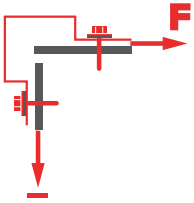
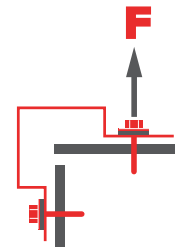
		$t_{NI}$ [mm]	$t_{II}$ [mm]						
			0,40	0,50	0,55	0,63	0,75	0,88	1,50
	$V_{R,k}$ [kN]	0,40	1,01	1,01	1,01	1,01	1,01	1,01	1,01
		0,50	1,52	1,52	1,52	1,52	1,52	1,52	1,52
		0,55	1,56	1,56	1,56	1,56	1,56	1,56	1,56
		0,63	1,63	1,63	1,63	1,63	1,63	1,63	1,63
		0,75	1,73	1,73	1,73	1,73	1,73	1,73	1,73
		0,88	1,73	2,71	2,71	2,71	2,71	2,71	2,71
		1,00	1,73	2,71	2,71	2,71	2,71	2,71	2,71
		1,13	1,73	2,71	2,71	2,71	2,71	2,71	2,71
		1,25	1,73	2,71	2,71	2,71	2,71	2,71	2,71
	$N_{R,k}$ [kN]	0,40	0,49	0,82	0,91	1,15	1,22	1,29	1,29
		0,50	0,49	0,82	0,91	1,15	1,22	1,98	1,98
		0,55	0,49	0,82	0,91	1,15	1,22	2,09	2,09
		0,63	0,49	0,82	0,91	1,15	1,22	2,09	2,09
		0,75	0,49	0,82	0,91	1,15	1,22	2,09	2,09
		0,88	0,49	0,82	0,91	1,15	1,22	2,09	2,09
		1,00	0,49	0,82	0,91	1,15	1,22	2,09	2,09
		1,13	0,49	0,82	0,91	1,15	1,22	2,09	2,09
		1,25	0,49	0,82	0,91	1,15	1,22	2,09	2,09

**Note**

1. Above mentioned values are characteristic values
2. To determine the design value we advise to apply a material factor of  $\gamma_m = 1,33$ .
3. You can find further information and calculation examples on page 10.1.7.

**STITCHING SCREWS - STEEL  $\leq 1,5$  MM - SS SUS410**

